

## INSTALLATION 初次安装

- 1** Make sure the power button at the bottom has been turned to "OFF", then open the battery cover.  
确认鼠标底部的电源开关已拨至“OFF”状态；

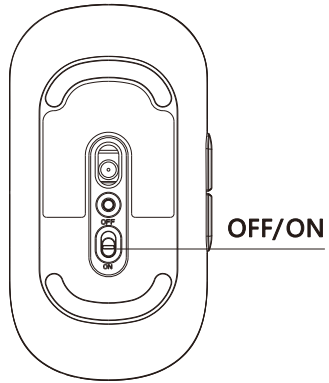

- 2** Press the cover and pull down to open (pull down directly can not open due to magnetic attached).  
开盖：轻按上盖并下拉即可。（因磁铁吸附功能，直接下拉，则无法打开）

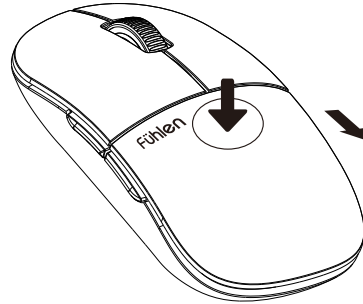

- 3** Put a AA battery in and take out the USB receiver, attach the cover and switch on the mouse.  
装入一节AA碱性电池，取出USB接收器并扣上电池上盖，将电源开关拨至“ON”位置；

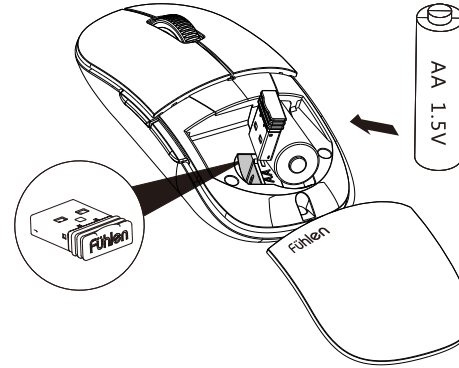

- 4** Plug the micro receiver into the USB port of your computer, press any key to start.  
将迷你USB接收器插入电脑USB端口，按任意键即可使用。

